

Faculty of Physical Education and Recreation

**PAW Centre
Design Development
Presentation**

October 21, 2011



Site Context



Site Plan

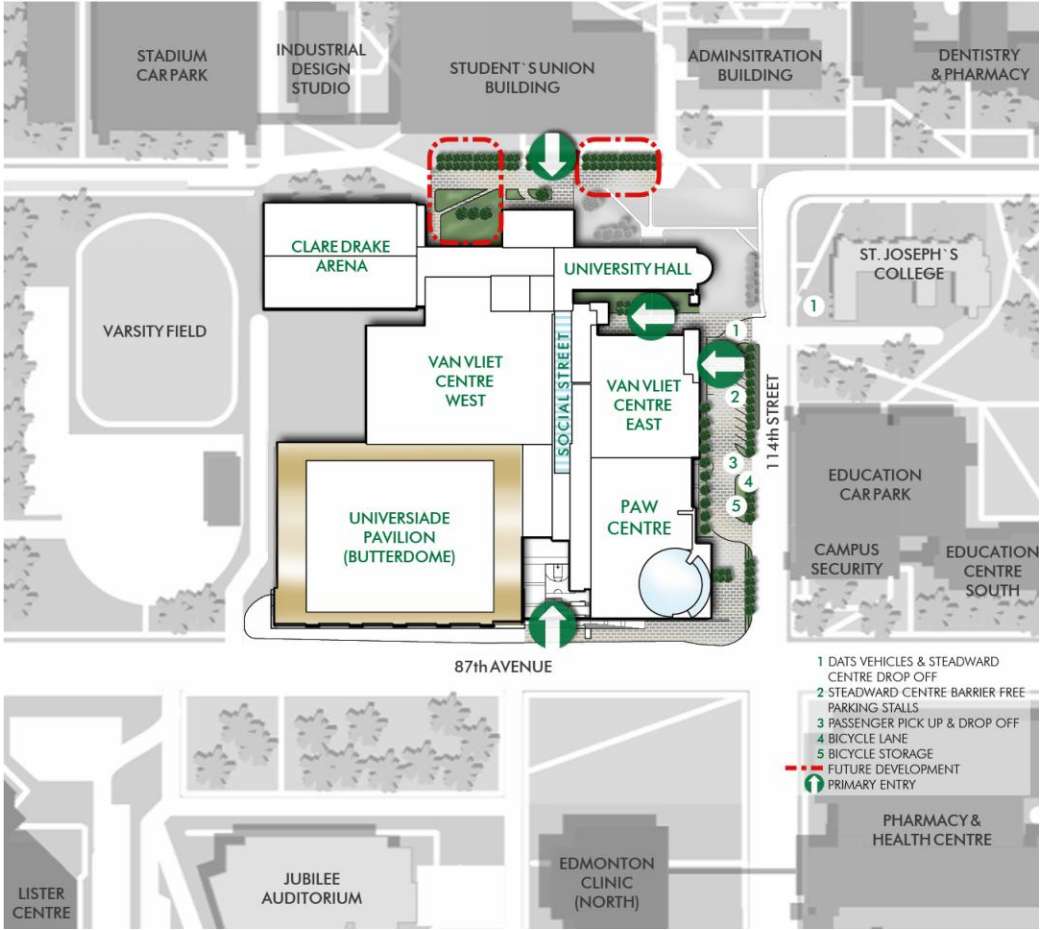

Site Plan

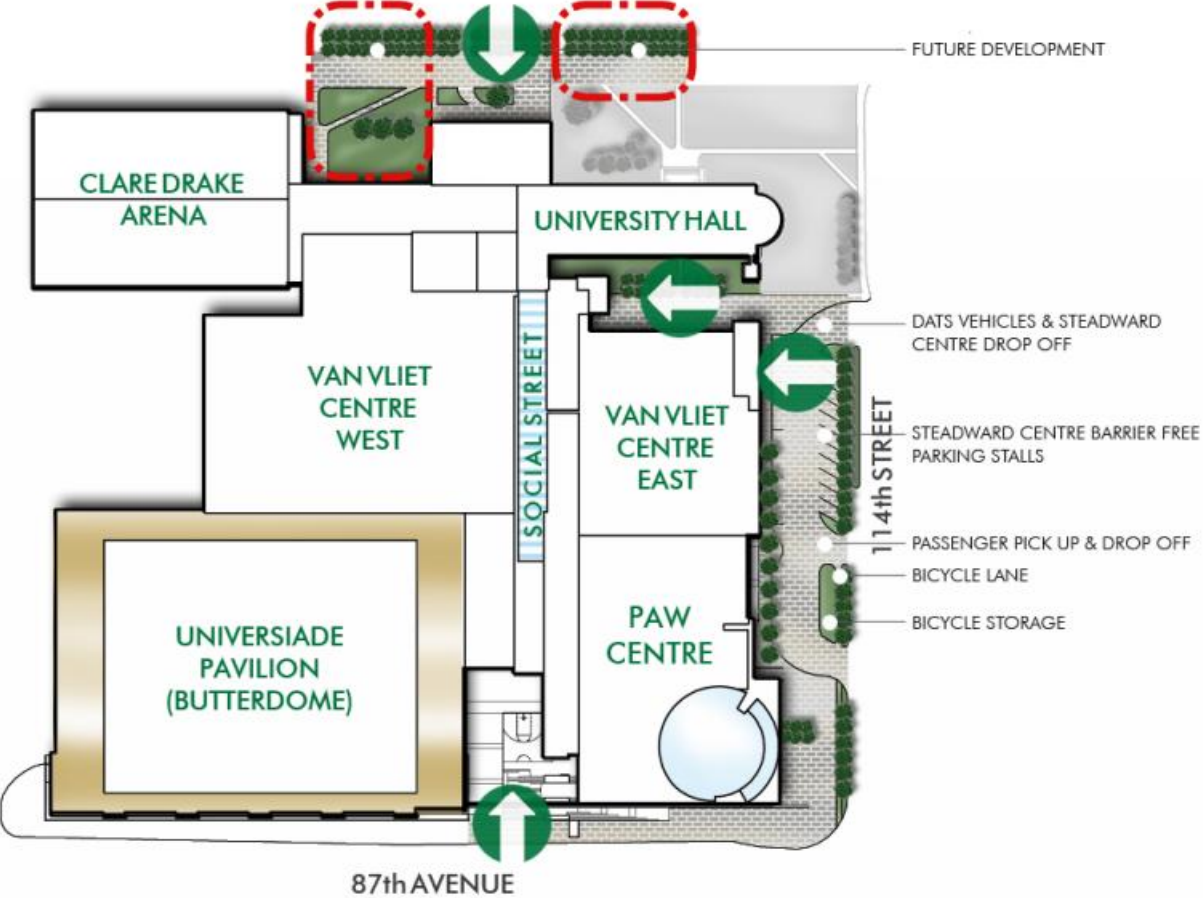

Quad Rendering



87th Avenue and 114th Street



North Entrance Rendering



South Entrance Rendering



Level 0

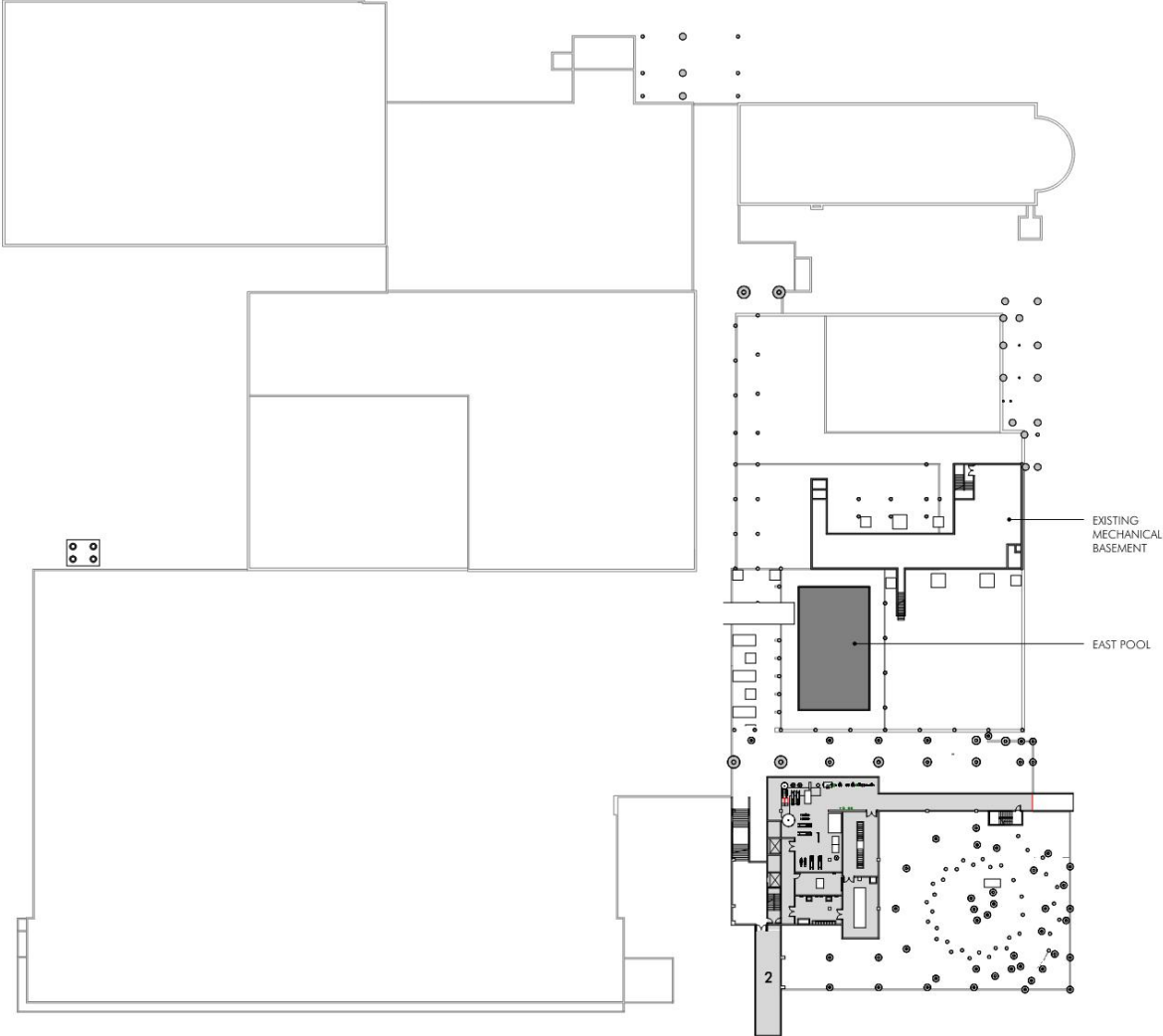

LEGEND

- STUDENT SERVICES
- CONCOURSE
- SERVICE



Level 1

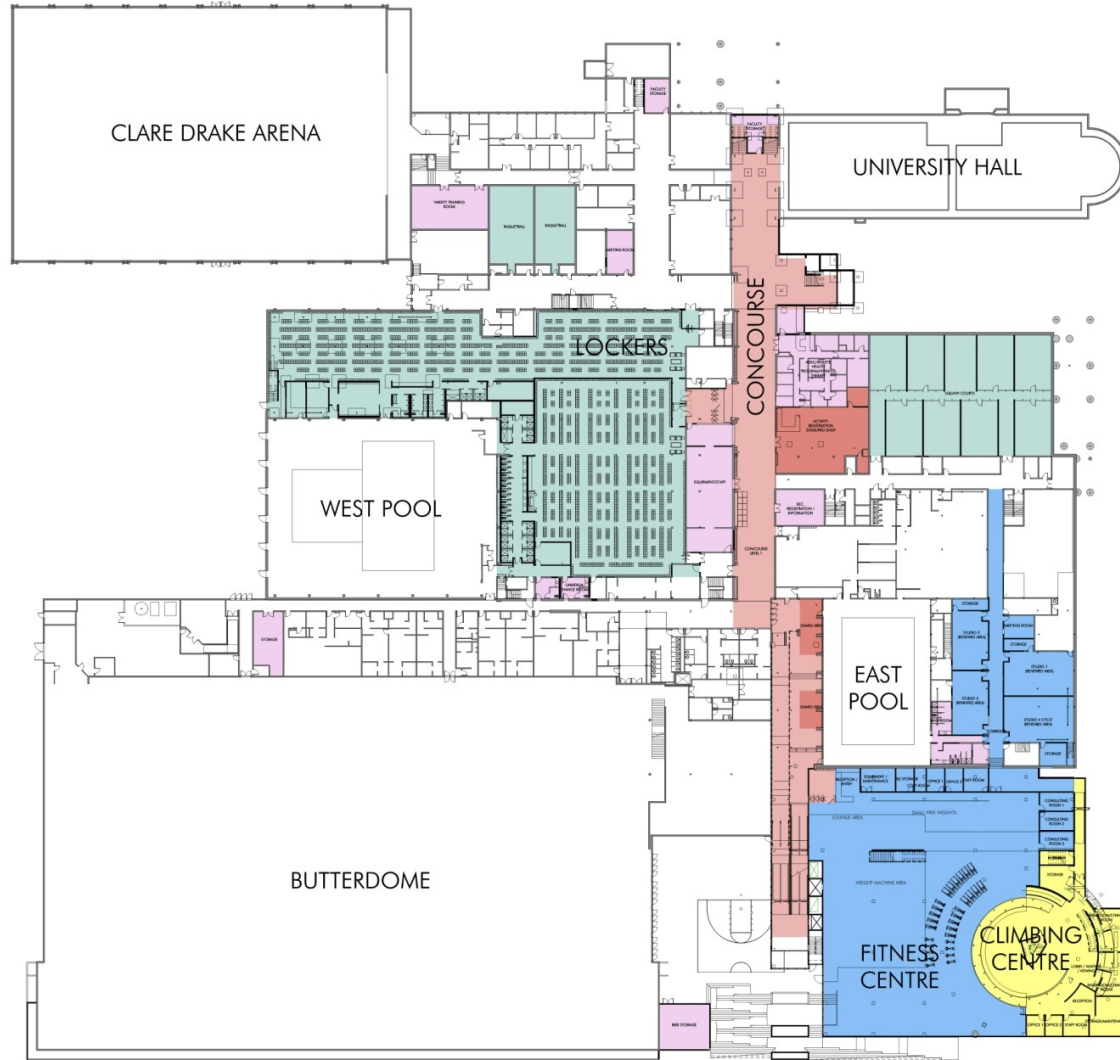

LEGEND

- STUDENT SERVICES
- CONCOURSE
- FITNESS AREA
- CLIMBING CENTRE
- RENEWED
- RENEWED - ADDITIONAL



Level 2



LEGEND

- STUDENT SERVICES
- CONCOURSE
- FITNESS AREA
- CLIMBING CENTRE
- RENEWED
- RENEWED - ADDITIONAL

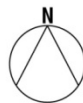

Social Street



Student Lounge / Gymnasium



Social Street







Fitness Centre

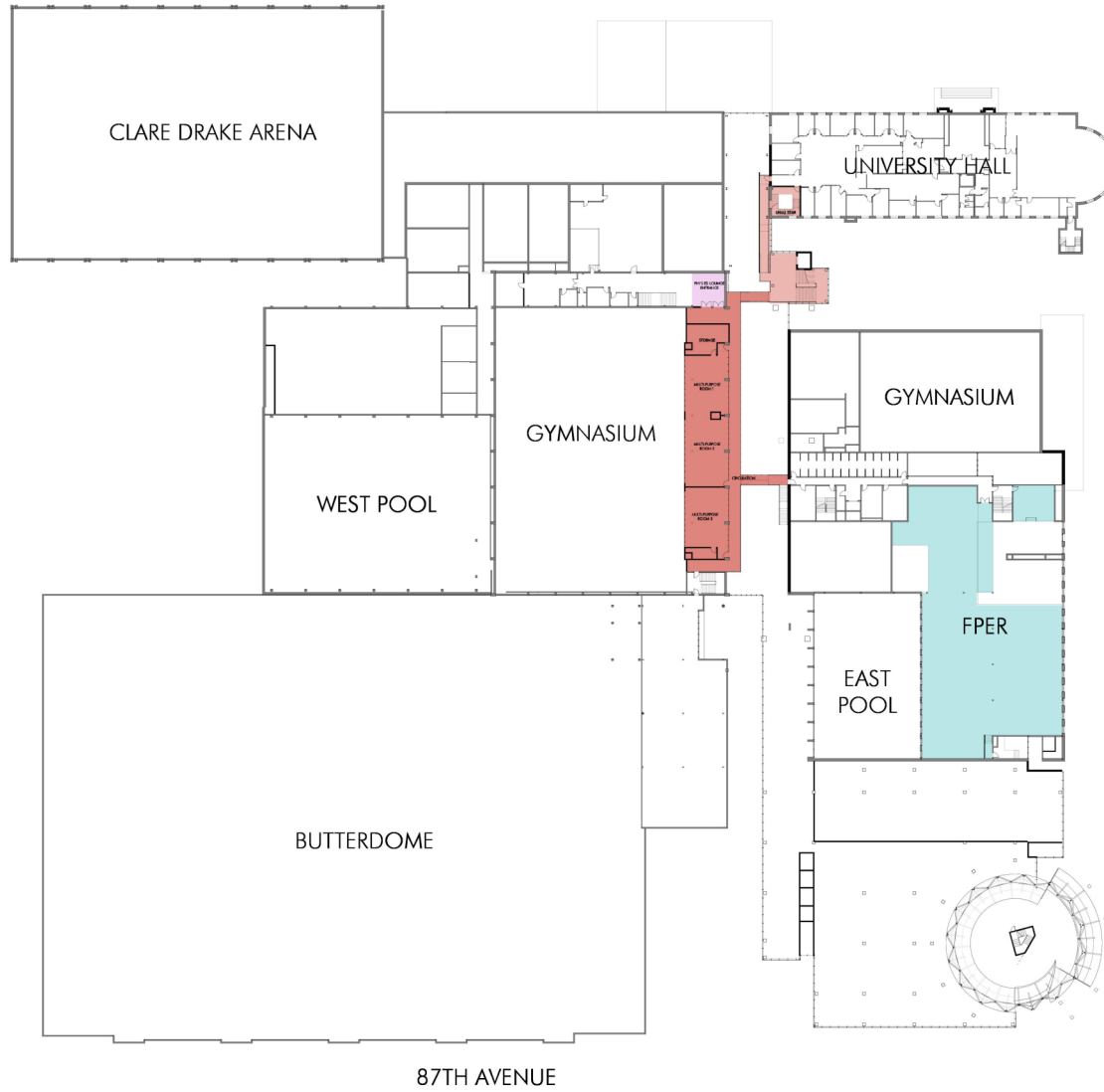

Level 3

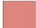

LEGEND

-  STUDENT SERVICES
-  CONCOURSE
-  RENEWED - ADDITIONAL
-  FACULTY OF PHYS. ED.



Mezzanine / Multi Purpose Rooms / Social Street



Level 4

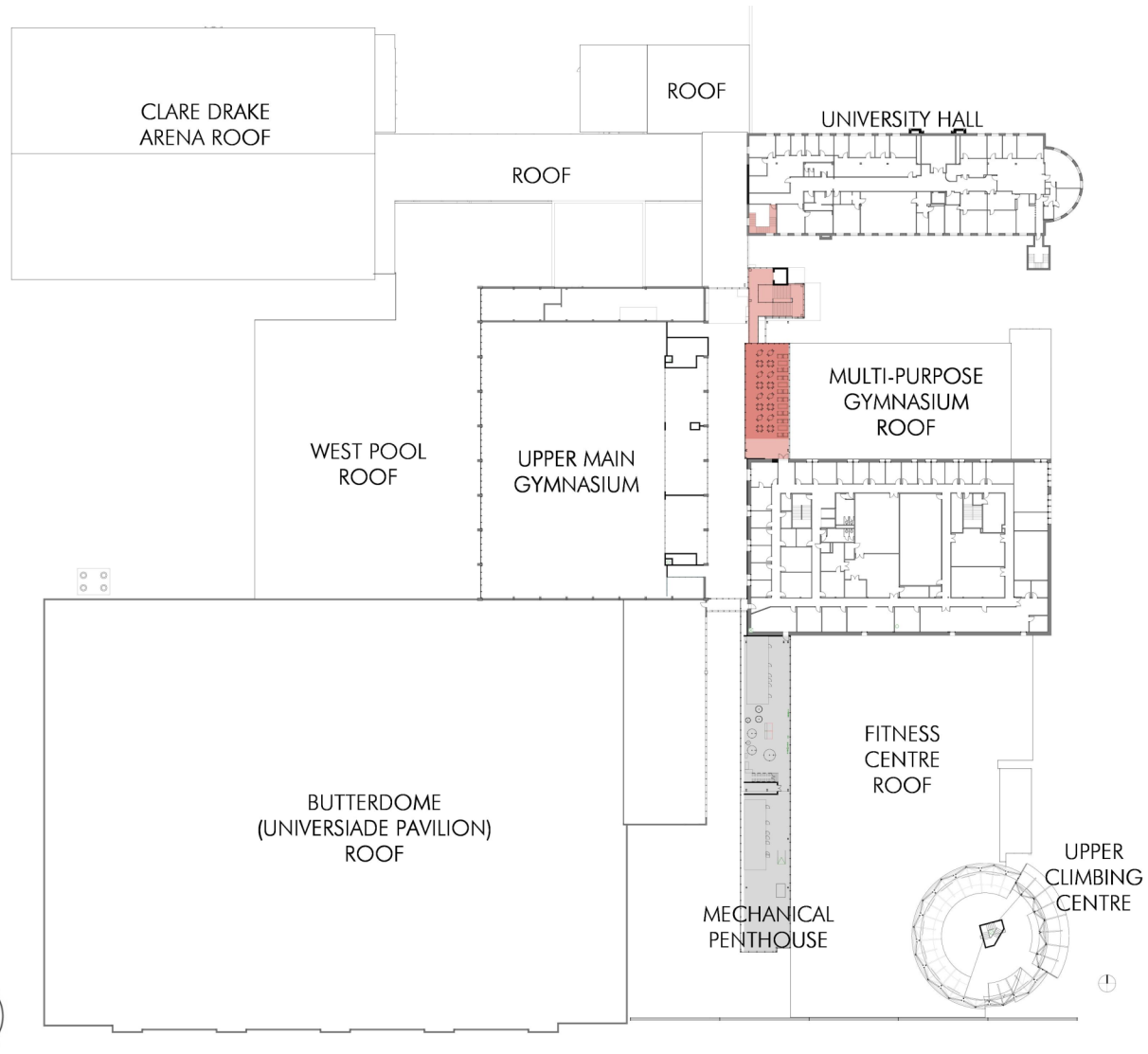

LEGEND

- STUDENT SERVICES
- CONCOURSE
- SERVICE

Area Summary

PAW CENTRE AREA SUMMARY			
Area Type	Design Development Gross Area	Schematic Design Gross Area	Functional Master Plan Program Area *
1.1 STUDENT SERVICES	1203.2 m ²	920.9 m ²	834.4 m ²
1.2 FITNESS AREA	3188.6 m ²	2840.8 m ²	2234.5 m ²
1.3 CLIMBING CENTRE	685.2 m ²	493.1 m ²	691.2 m ²
2.1 CONCOURSE	2752.3 m ²	3256.2 m ²	3576.3 m ²
3.1 FACULTY OF PHYS. ED.	935.4 m ²	1225.6 m ²	1243.1 m ²
3.2 STEADWARD CENTRE	2029.1 m ²	1846.6 m ²	1915.6 m ²
3.3 RENEWED	3962.4 m ²	3214.6 m ²	3859.0 m ²
3.4 RENEWED - ADDITIONAL **	1425.7 m ²	1595.6 m ²	0.0 m ²
4.1 SERVICE **	1247.6 m ²	407.5 m ²	0.0 m ²
Grand total	17429.5 m ²	15800.9 m ²	14354.0 m ²

* Program Area is grossed up from Net Assignable (refer to individual Area Type for factor specific to that section)

** This area was not included in the original Functional Master Plan program

Concourse Area

CONCOURSE AREA SUMMARY				
Room Name	Design Development Gross Area	Schematic Design Gross Area	Functional Master Plan Program Area *	Comments
LEVEL 1				
CONCOURSE LEVEL 1	1247.5 m ²	1744.3 m ²	408.8 m ²	
	1247.5 m ²	1744.3 m ²	408.8 m ²	
LEVEL 2				
CONCOURSE LEVEL 2	992.1 m ²	1264.9 m ²	3167.5 m ²	
EAST STAIR	127.8 m ²	0.0 m ²	0.0 m ²	
NORTH VESTIBULE	42.6 m ²	0.0 m ²	0.0 m ²	
SOUTH VESTIBULE	50.7 m ²	0.0 m ²	0.0 m ²	
UHALL STAIR	27.4 m ²	0.0 m ²	0.0 m ²	
	1240.7 m ²	1264.9 m ²	3167.5 m ²	
LEVEL 3				
EAST STAIR/ELEVATOR	113.6 m ²	247.0 m ²	0.0 m ²	
UHALL STAIR	20.1 m ²	0.0 m ²	0.0 m ²	
	133.7 m ²	247.0 m ²	0.0 m ²	
LEVEL 4				
EAST STAIR/ELEVATOR	86.3 m ²	0.0 m ²	0.0 m ²	
UHALL STAIR	14.2 m ²	0.0 m ²	0.0 m ²	
VESTIBULE	29.9 m ²	0.0 m ²	0.0 m ²	
	130.3 m ²	0.0 m ²	0.0 m ²	
Grand total	2752.3 m ²	3256.2 m ²	3576.3 m ²	

* Gross up factors of 2% for circulation & walls and 7% for mechanical, electrical & structural allowances (9% total) are included in Program Area values

Climbing Centre Area

CLIMBING CENTRE AREA				
Room Name	Design Development Gross Area	Schematic Design Gross Area	Functional Master Plan Program Area *	Comments
GRADE				
CLIMBING CENTRE ENTRANCE	28.7 m ²	0.0 m ²	0.0 m ²	
	28.7 m ²	0.0 m ²	0.0 m ²	
LEVEL 1				
CLIMBING CENTRE	300.5 m ²	298.7 m ²	483.1 m ²	vertical bouldering to be developed
CORRIDOR	35.4 m ²	0.0 m ²	0.0 m ²	
LOBBY / WAITING / VIEWING	102.2 m ²	64.9 m ²	92.0 m ²	
OFFICE 1	12.5 m ²	16.3 m ²	13.8 m ²	
OFFICE 2	11.4 m ²	0.0 m ²	0.0 m ²	
RECEPTION	21.0 m ²	20.8 m ²	17.3 m ²	
STAFF ROOM	17.0 m ²	24.9 m ²	17.5 m ²	
STAIR	15.8 m ²	0.0 m ²	0.0 m ²	
STORAGE	31.3 m ²	24.9 m ²	0.0 m ²	
STORAGE/MAINTENANCE	39.7 m ²	24.9 m ²	40.0 m ²	
WASHROOM/CHANGE ROOM	69.4 m ²	17.6 m ²	27.6 m ²	
	656.5 m ²	493.1 m ²	691.2 m ²	
Grand total	685.2 m ²	493.1 m ²	691.2 m ²	

* Gross up factors of 8% for circulation & walls and 7% for mechanical, electrical & structural allowances (15% total) are included in Program Area values

Fitness Centre Area

FITNESS CENTRE AREA				
Room Name	Design Development Gross Area	Schematic Design Gross Area	Functional Master Plan Program Area *	Comments
LEVEL 1				
CONSULTING LARGE	21.4 m ²	21.1 m ²	23.0 m ²	
CONSULTING ROOM 1	20.4 m ²	13.8 m ²	20.7 m ²	
CONSULTING ROOM 2	20.8 m ²	13.8 m ²	20.7 m ²	
COPY ROOM	9.2 m ²	6.4 m ²	4.6 m ²	
CORRIDOR	201.4 m ²	39.5 m ²	0.0 m ²	
EQUIPMENT / MAINTENANCE	26.7 m ²	25.7 m ²	27.6 m ²	
FILE STORAGE	14.0 m ²	11.9 m ²	12.7 m ²	
FITNESS CENTRE	1455.9 m ²	1370.4 m ²	1000.0 m ²	
MEETING ROOM	22.9 m ²	22.9 m ²	0.0 m ²	
OFFICE 1	14.0 m ²	12.8 m ²	12.7 m ²	
OFFICE 2	14.0 m ²	13.0 m ²	12.7 m ²	
RECEPTION / ENTRY	26.9 m ²	22.3 m ²	18.4 m ²	
STAFF ROOM	19.1 m ²	0.0 m ²	0.0 m ²	
STORAGE	51.8 m ²	39.6 m ²	23.0 m ²	
STUDIO 1 (RENEWED AREA)	97.9 m ²	97.9 m ²	97.8 m ²	
STUDIO 2 (RENEWED AREA)	66.1 m ²	78.3 m ²	97.8 m ²	
STUDIO 3 (RENEWED AREA)	70.0 m ²	78.9 m ²	97.8 m ²	
STUDIO 4 CYCLE (RENEWED AREA)	101.5 m ²	101.5 m ²	97.8 m ²	
	2254.2 m ²	1969.5 m ²	1567.0 m ²	
LEVEL 2				
FITNESS CENTRE	934.4 m ²	871.4 m ²	667.5 m ²	
	934.4 m ²	871.4 m ²	667.5 m ²	
Grand total	3188.6 m ²	2840.8 m ²	2234.5 m ²	

* Gross up factors of 8% for circulation & walls and 7% for mechanical, electrical & structural allowances (15% total) are included in Program Area values

FPER Area

FACULTY OF PHYSICAL EDUCATION AND RECREATION SHELL SPACE				
Room Name	Design Development Gross Area	Schematic Design Gross Area	Functional Master Plan Program Area *	Comments
LEVEL 3				
SHELL SPACE	984.4 m ²	1225.6 m ²	1243.1 m ²	
Grand total	984.4 m ²	1225.6 m ²	1243.1 m ²	

* Gross up factors of 18% for circulation & walls and 7% for mechanical, electrical & structural allowances (25% total) are included in Program Area values



Service Space Area

SERVICE SPACE				
Room Name	Design Development Gross Area	Schematic Design Gross Area	Functional Master Plan Program Area	Comments
LEVEL 0				
LINK	112.6 m ²	0.0 m ²	0.0 m ²	
MECHANICAL/ELECTRICAL BASEMENT	546.0 m ²	0.0 m ²	0.0 m ²	
UTILIDOR	91.0 m ²	0.0 m ²	0.0 m ²	
	749.6 m ²	0.0 m ²	0.0 m ²	
LEVEL 4				
MECHANICAL PENTHOUSE	498.1 m ²	407.5 m ²	0.0 m ²	
	498.1 m ²	407.5 m ²	0.0 m ²	
Grand total	1247.6 m ²	407.5 m ²	0.0 m ²	

Renewed Area

RENEWED SPACE				
Room Name	Design Development Gross Area	Schematic Design Gross Area	Functional Master Plan Program Area *	Comments
LEVEL 1				
ADDITION TO WEST	0.0 m ²	0.0 m ²	820.0 m ²	
COMPETITION SQUASH COURTS	221.3 m ²	221.3 m ²	360.0 m ²	2 courts
LOCKER ROOMS	2307.9 m ²	2271.1 m ²	1280.0 m ²	
SQUASH COURTS	697.1 m ²	722.2 m ²	817.0 m ²	
	3226.3 m ²	3214.6 m ²	3277.0 m ²	
LEVEL 2				
CORRIDOR	39.8 m ²	0.0 m ²	0.0 m ²	
DANCE STORAGE	39.2 m ²	0.0 m ²	0.0 m ²	
DANCE STUDIO	622.5 m ²	0.0 m ²	582.0 m ²	8 courts
STORAGE	34.6 m ²	0.0 m ²	0.0 m ²	
	736.1 m ²	0.0 m ²	582.0 m ²	
Grand total	3962.4 m ²	3214.6 m ²	3859.0 m ²	

* There are no gross up factors applied to these Program Area values as spaces are existing (no gross up amount is required for Addition to West Program Area)

Renewed Additional Area

RENEWED - ADDITIONAL SPACE				
Room Name	Design Development Gross Area	Schematic Design Gross Area	Functional Master Plan Program Area	Comments
LEVEL 1				
ASDC/ATHLETE HEALTH PROGRAM/ATHLETIC THERAPY	225.0 m ²	308.6 m ²	0.0 m ²	current Glen Sather Clinic
BIKE STORAGE	70.0 m ²	0.0 m ²	0.0 m ²	
EQUIPMENT/STAFF	191.1 m ²	191.1 m ²	0.0 m ²	point of entry move
FACULTY STORAGE	59.8 m ²	121.9 m ²	0.0 m ²	
MEETING ROOM	38.5 m ²	38.5 m ²	0.0 m ²	replaces W1-14
REC. REGISTRATION / INFORMATION STORAGE	55.6 m ²	55.6 m ²	0.0 m ²	displaced by locker expansion
UNIVERSAL CHANGE ROOMS	53.5 m ²	0.0 m ²	0.0 m ²	
VARSITY TRAINING ROOM	38.6 m ²	38.6 m ²	0.0 m ²	
WASHROOMS	108.7 m ²	108.7 m ²	0.0 m ²	current reving room
	72.1 m ²	0.0 m ²	0.0 m ²	
	912.9 m ²	863.1 m ²	0.0 m ²	
LEVEL 2				
CLASSROOMS/LABS	177.6 m ²	177.6 m ²	0.0 m ²	repurpose current Steadward Centre
FACULTY RECEPTION	77.9 m ²	48.3 m ²	0.0 m ²	
HALL OF FAME	149.4 m ²	179.0 m ²	0.0 m ²	
MEETING ROOM	70.5 m ²	70.5 m ²	0.0 m ²	repurpose current Steadward Centre
	475.5 m ²	475.5 m ²	0.0 m ²	
LEVEL 3				
PHYS ED LOUNGE ENTRANCE	37.3 m ²	257.0 m ²	0.0 m ²	
	37.3 m ²	257.0 m ²	0.0 m ²	
Grand total	1425.7 m ²	1595.6 m ²	0.0 m ²	

Student Services Area

STUDENT SERVICES AREA				
Room Name	Design Development Gross Area	Schematic Design Gross Area	Functional Master Plan Program Area *	Comments
LEVEL 1				
ACTIVITY REGISTRATION ZONE/PRO SHOP	201.1 m ²	107.9 m ²	44.8 m ²	shared with FPER
GAMES AREA	68.5 m ²	68.3 m ²	67.2 m ²	
	269.6 m ²	176.2 m ²	112.0 m ²	
LEVEL 2				
COMMUNITY/TEACHING KITCHEN	80.0 m ²	80.0 m ²	89.6 m ²	
FOOD SERVICES VENDOR	87.4 m ²	87.4 m ²	44.8 m ²	
STUDENT LOUNGE	119.6 m ²	131.8 m ²	156.8 m ²	
	287.0 m ²	299.2 m ²	291.2 m ²	
LEVEL 3				
CIRCULATION	168.9 m ²	0.0 m ²	0.0 m ²	
MULTI-PURPOSE ROOM 1	89.8 m ²	110.1 m ²	134.4 m ²	
MULTI-PURPOSE ROOM 2	101.5 m ²	111.7 m ²	95.2 m ²	
MULTI-PURPOSE ROOM 3	102.4 m ²	196.1 m ²	0.0 m ²	
STORAGE	40.7 m ²	27.6 m ²	0.0 m ²	
	503.2 m ²	445.5 m ²	229.6 m ²	
LEVEL 4				
GRAD LOUNGE & STUDY	143.5 m ²	0.0 m ²	201.6 m ²	
	143.5 m ²	0.0 m ²	201.6 m ²	
Grand total	1203.2 m ²	920.9 m ²	834.4 m ²	

* Gross up factors of 5% for circulation & walls and 7% for mechanical, electrical & structural allowances (12% total) are included in Program Area values

Steadward Centre Area

STEADWARD CENTRE AREA				
Room Name	Design Development Gross Area	Schematic Design Gross Area	Functional Master Plan Program Area *	Comments
LEVEL 2				
2 HOTELING STATIONS	10.1 m ²	10.1 m ²	7.8 m ²	
CIRCULATION	222.2 m ²	249.2 m ²	0.0 m ²	23% circulation allowance included within each program area
COAT STORAGE	9.0 m ²	9.2 m ²	9.1 m ²	
COPY ROOM	16.8 m ²	16.2 m ²	15.6 m ²	
ENTRANCE	149.7 m ²	0.0 m ²	0.0 m ²	
EQUIPMENT STORAGE AND REPAIR	82.1 m ²	74.1 m ²	123.5 m ²	
FAMILY WAITING AREA	12.8 m ²	14.2 m ²	0.0 m ²	
FILE STORAGE	13.3 m ²	13.3 m ²	19.5 m ²	
FITNESS CENTRE	353.0 m ²	315.6 m ²	455.0 m ²	
FREE TO BE ME	472.8 m ²	449.3 m ²	520.0 m ²	
GRADUATE LAB	15.7 m ²	15.7 m ²	19.5 m ²	
INTERVIEW ROOM	22.9 m ²	22.9 m ²	26.0 m ²	
KITCHENETTE	10.5 m ²	10.5 m ²	15.6 m ²	
LOCKER AREA	47.2 m ²	40.4 m ²	39.0 m ²	
MEETING ROOM	23.3 m ²	23.3 m ²	26.0 m ²	
OFFICE	53.4 m ²	53.4 m ²	42.9 m ²	
OFFICE - EXECUTIVE DIRECTOR	14.0 m ²	14.0 m ²	18.2 m ²	
PHYSICAL ASSESSMENT LAB	45.5 m ²	49.1 m ²	52.0 m ²	replaces FES Multi-Purpose / Rehab Lab
PRIVACY ROOM (OFFICE)	9.4 m ²	9.4 m ²	9.8 m ²	
PROGRAM PREP / VOLUNTEER LOUNGE / KITCHENETTE	31.4 m ²	29.6 m ²	0.0 m ²	client requested
PSYCHOLOGICAL SOCIAL LAB	44.1 m ²	44.1 m ²	52.0 m ²	
PUBLIC LOBBY SPACE	89.6 m ²	89.6 m ²	130.0 m ²	
RECEPTION	17.8 m ²	17.8 m ²	15.6 m ²	
SEMINAR / CONFERENCE ROOM	61.8 m ²	61.8 m ²	78.0 m ²	
SERVER ROOM	6.2 m ²	6.2 m ²	6.5 m ²	
SHOWER ROOMS	49.5 m ²	45.3 m ²	78.0 m ²	4 washrooms with showers provided
WASHROOMS	39.9 m ²	56.6 m ²	39.0 m ²	
WORKSTATIONS	105.2 m ²	105.2 m ²	117.0 m ²	18 workstations
Grand total	2029.1 m ²	1846.6 m ²	1915.6 m ²	

* Gross up factors of 23% for circulation & walls and 7% for mechanical, electrical & structural allowances (30% total) are included in Program Area values



Certified 40-49points
Silver 50-59 points
 Gold 60-79 points
 Platinum 80-110 points

LEED 2009 for New Construction and Major Renovations

Project Checklist

The University of Alberta - Physical Activity and Wellness (PAW) Centre

February 1, 2011

20 6 Sustainable Sites Possible Points: 26

Y	?	N			
			Prereq 1	Construction Activity Pollution Prevention	
1			Credit 1	Site Selection	1
5			Credit 2	Development Density and Community Connectivity	5
	1		Credit 3	Brownfield Redevelopment	1
6			Credit 4.1	Alternative Transportation—Public Transportation Access	6
1			Credit 4.2	Alternative Transportation—Bicycle Storage and Changing Rooms	1
		3	Credit 4.3	Alternative Transportation—Low-Emitting and Fuel-Efficient Vehicles	3
2			Credit 4.4	Alternative Transportation—Parking Capacity	2
	1		Credit 5.1	Site Development—Protect or Restore Habitat	1
1			Credit 5.2	Site Development—Maximize Open Space	1
1			Credit 6.1	Stormwater Design—Quantity Control	1
1			Credit 6.2	Stormwater Design—Quality Control	1
1			Credit 7.1	Heat Island Effect—Non-roof	1
	1		Credit 7.2	Heat Island Effect—Roof	1
1			Credit 8	Light Pollution Reduction	1

8 Water Efficiency Possible Points: 10

Y	?	N			
			Prereq 1	Water Use Reduction—20% Reduction	
4			Credit 1	Water Efficient Landscaping	2 to 4
2			Credit 2	Innovative Wastewater Technologies	2
2			Credit 3	Water Use Reduction	2 to 4

12 1 5 Energy and Atmosphere Possible Points: 35

Y	?	N			
			Prereq 1	Fundamental Commissioning of Building Energy Systems	
			Prereq 2	Minimum Energy Performance	
			Prereq 3	Fundamental Refrigerant Management	
8			Credit 1	Optimize Energy Performance	1 to 19
	1		Credit 2	On-Site Renewable Energy	1 to 7
2			Credit 3	Enhanced Commissioning	2
2			Credit 4	Enhanced Refrigerant Management	2
		3	Credit 5	Measurement and Verification	3
		2	Credit 6	Green Power	2

6 5 3 Materials and Resources Possible Points: 14

Y	?	N			
			Prereq 1	Storage and Collection of Recyclables	
1		2	Credit 1.1	Building Reuse—Maintain Existing Walls, Floors, and Roof	1 to 3
		1	Credit 1.2	Building Reuse—Maintain 50% of Interior Non-Structural Elements	1
2			Credit 2	Construction Waste Management	1 to 2
	2		Credit 3	Materials Reuse	1 to 2

Materials and Resources, Continued

Y	?	N			
1	1		Credit 4	Recycled Content	1 to 2
1	1		Credit 5	Regional Materials	1 to 2
	1		Credit 6	Rapidly Renewable Materials	1
1			Credit 7	Certified Wood	1

7 2 6 Indoor Environmental Quality Possible Points: 15

Y	?	N			
			Prereq 1	Minimum Indoor Air Quality Performance	
			Prereq 2	Environmental Tobacco Smoke (ETS) Control	
		1	Credit 1	Outdoor Air Delivery Monitoring	1
		1	Credit 2	Increased Ventilation	1
1			Credit 3.1	Construction IAQ Management Plan—During Construction	1
1			Credit 3.2	Construction IAQ Management Plan—Before Occupancy	1
1			Credit 4.1	Low-Emitting Materials—Adhesives and Sealants	1
1			Credit 4.2	Low-Emitting Materials—Paints and Coatings	1
1			Credit 4.3	Low-Emitting Materials—Flooring Systems	1
		1	Credit 4.4	Low-Emitting Materials—Composite Wood and Agrifiber Products	1
		1	Credit 5	Indoor Chemical and Pollutant Source Control	1
1			Credit 6.1	Controllability of Systems—Lighting	1
		1	Credit 6.2	Controllability of Systems—Thermal Comfort	1
1			Credit 7.1	Thermal Comfort—Design	1
		1	Credit 7.2	Thermal Comfort—Verification	1
		1	Credit 8.1	Daylight and Views—Daylight	1
		1	Credit 8.2	Daylight and Views—Views	1

6 Innovation and Design Process Possible Points: 6

Y	?	N			
1			Credit 1.1	Innovation in Design: Exceptional Water Use Reduction	1
1			Credit 1.2	Innovation in Design: Exceptional Waste Water Reduction	1
1			Credit 1.3	Innovation in Design: Green Education	1
1			Credit 1.4	Innovation in Design: Green Housekeeping	1
1			Credit 1.5	Innovation in Design: Sustain. Sites: Exceptional Public Transit Access	1
1			Credit 2	LEED Accredited Professional	1

4 Regional Priority Credits Possible Points: 4

Y	?	N			
		1	Credit 1.1	Regional Priority: Specific Credit	1
		1	Credit 1.2	Regional Priority: Specific Credit	1
		1	Credit 1.3	Regional Priority: Specific Credit	1
		1	Credit 1.4	Regional Priority: Specific Credit	1

59 8 24 Total Possible Points: 110

Certified 40 to 49 points Silver 50 to 59 points Gold 60 to 79 points Platinum 80 to 110

Sustainability

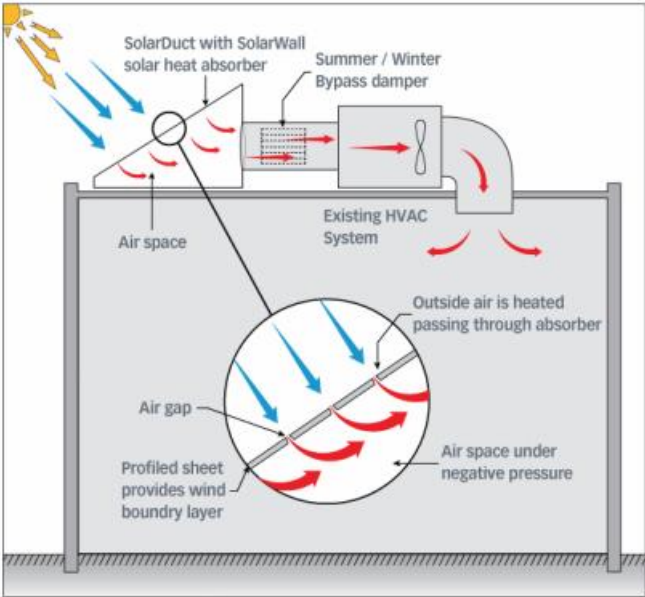

Sustainability

